



01452 690553



sales@applebys.estate



www.applebysestateagents.co.uk



Field Court Farmhouse Courtfield Road

, Quedgeley, GL2 4WQ

£169,950

 2  2  1  E

This charming two-bedroom mid-terraced home, nestled within the sought-after Over 55s complex of Field Court Farmhouse in Quedgeley, benefitting its own courtyard garden and allocated parking.

This property offers a wonderful opportunity for those seeking a comfortable and secure living environment in a popular location***CHAIN FREE***



Entrance Hall

Lounge 15'5 x 10'5 (4.70m x 3.18m)

Kitchen 8'11 x 7'1 (2.72m x 2.16m)

Dining Room 9'10 x 8'11 (3.00m x 2.72m)

Shower Room

Bedroom 1 14'1 x 12'2 (4.29m x 3.71m)

Bedroom 2 9'1 x 8'8 (2.77m x 2.64m)

Bathroom

OUTSIDE

Allocated parking space to the front, pathway leads to the property with the communal gardens to the front is a very pleasant outlook.

The enclosed court yard rear garden is low maintenance with garden shed.

Services

Mains drainage, electric heating
Gloucester City Council tax band B

Tenure

Freehold

There is a monthly maintenance cost of approx £90 per month for the upkeep of the communal area

Area Map

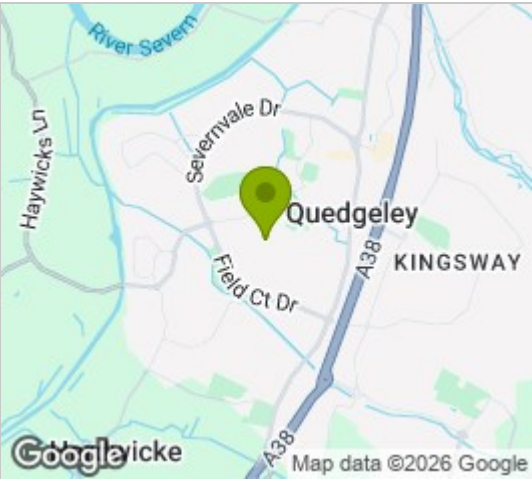

Floor Plans

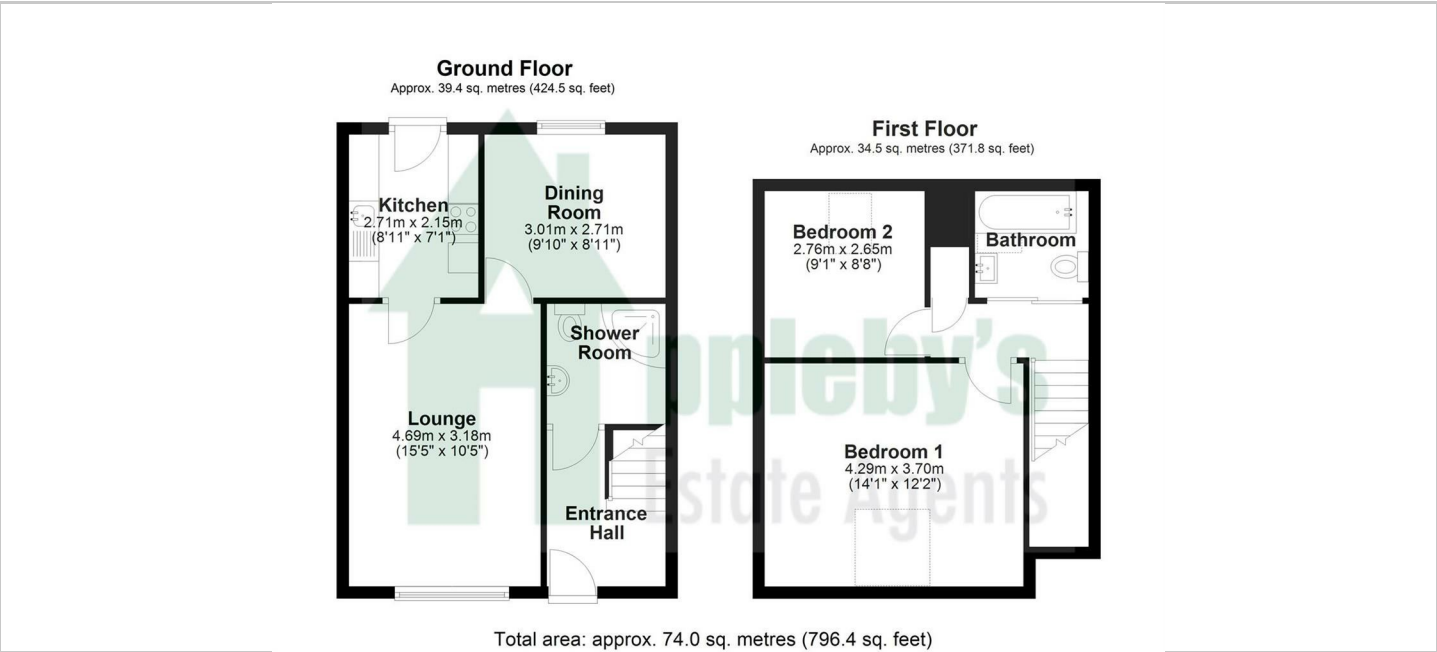

Energy Efficiency Graph

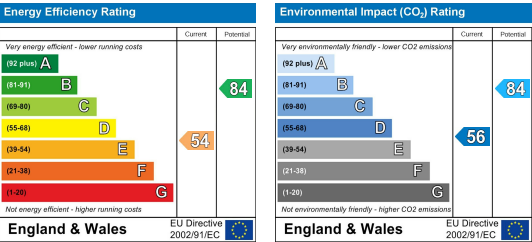

These particulars, whilst believed to be accurate are set out as a general outline only for guidance and do not constitute any part of an offer or contract. Intending purchasers should not rely on them as statements of representation of fact, but must satisfy themselves by inspection or otherwise as to their accuracy. No person in this firms employment has the authority to make or give any representation or warranty in respect